

Characteristics

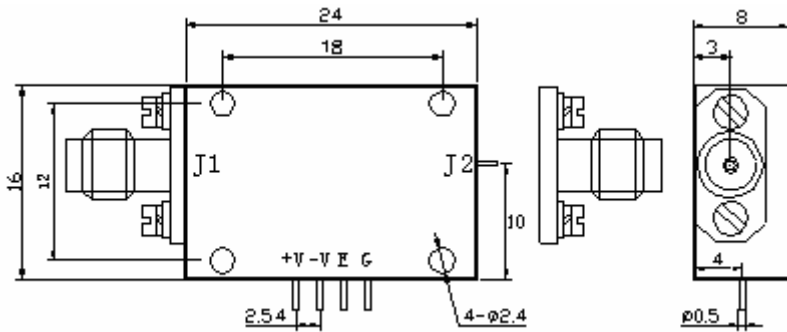

Wide Bandwidth
Low Insertion
High Isolation
High Speed
TTL Control

Notes: Frequency range, insertion loss, isolation, power rating and connection type, control mode and outline can be customized. And different application condition can also be customized.

Specifications

Part Number	Frequency Range(GHz)	Insertion Loss (dB) max	Isolation (dB) min	VSWR max	Switch Speed (ns) max	PowerRating cw (w)	Outline
LT-CK12110	0.01—1.0	0.6	60	1.3	1000	0.5	
LT-CK12120	1.0—2.0	0.6	60	1.3	50	0.5	
LT-CK12130	2.0—4.0	0.8	60	1.4	50	0.5	
LT-CK12140	4.0—8.0	1.2	60	1.6	50	0.5	
LT-CK12150	8.0—12.0	1.4	60	1.8	50	0.5	
LT-CK12160	12.0—18.0	2.0	60	2.0	50	0.5	
LT-CK12170	2.0—8.0	1.4	60	1.6	50	0.5	
LT-CK12180	8.0—18.0	2.0	60	2.0	50	0.5	
LT-CK12190	2.0—18.0	2.0	60	2.0	50	0.5	

Application Notes

1. Power supply: Input from +V lead to +5V, current can be no more than 30mA ;From -V lead to -5V, current can only be up to 30mA ;
2. Control mode: When TTL input from E lead and TTL is "0", voltage is now 0-0.8V, switch is off ; When TTL is high as "1", voltage is 2-5.5V and switch now is on.
3. Be sure if power supply is right connected and voltage can be no more than 20% of rated;

Eleading Technologies Ltd.

F5102, Yunshenchu, Yuanlin Rd., Shatoujiao, Shenzhen, China. Zip 518081. Phn. ++86,755,2528 5648 Fax.2528

eleading@vip.163.com sales@eleadingchina.com www.eleadingchina.com