

Electrical Specifications

Part Number	Frequency Range(GHz)	Bandwidth	Insertion Loss(dB)	VSWR	Leakage (dBm)	Power Rating(W)		Package
						CW	PK	
LT-C632XA	1.0~2.0	30%	0.6	1.3	13	4	40 ^a	B14/B31/S17
LT-C633XA	2.0~4.0	25%	0.9	1.5	13	4	40 ^a	B14/B31/S17
LT-C634XA	4.0~8.0	20%	1.2	1.5	13	4	40 ^a	B14/B31/S17
LT-C635XA	8.0~12.0	15%	1.5	1.5	13	4	40 ^a	B14/B31/S17
LT-C636XA	12.0~18.0	15%	1.9	1.6	13	4	40 ^a	B14/B31/S17

Note: Pulse bandwidth= μ s; duty cycle =10%;

For specific drawing, please contact factory;

Outline Drawing

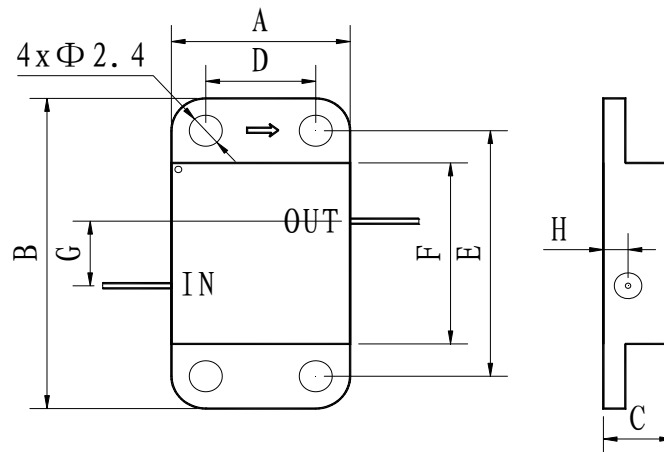

Application notes

1. While operating, RF ports should be isolated, and the crust should be connected to DC ground.
2. These devices sensitive to electrostatic discharge (ESD) and can be damaged by static electricity. Proper ESD control techniques should used when handling these devices.

Eleading Technologies Ltd.

F5102, Yunshenchu, Yuanlin Rd., Shatoujiao, Shenzhen, China. Zip 518081. Phn. ++86,755,2528 5648 Fax.2528

eleading@vip.163.com sales@eleadingchina.com www.eleadingchina.com