

Electrical Specifications

Part Number	Frequency Range (GHz)	Relative Bandwidth	Insertion Loss (dB) max	Clip Level (mw) max	VSWR max	Power Rating(w)	Waveguide Type
LT-CX13420	1–2	10%	0.4	20	1.20	100	WR510
LT-CX13430	2–4	10%	0.5	20	1.20	80	WR284
LT-CX13440	4–8	10%	0.6	20	1.30	50	WR159
LT-CX13450	8–12	8%	0.8	20	1.40	40	WR90
LT-CX13460	12–18	5%	1.2	20	1.50	30	WR75

Note:

- 1.Input power =peak power; duty cycle=1%pulse width=100 μ S max
- 2.The dimensions of the products are related to different waveguide type.
The other waveguide type is available at request.

Outline Drawing

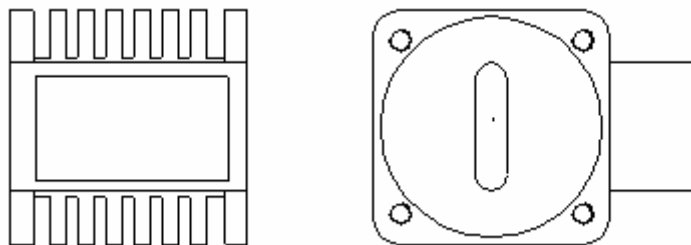

Eleading Technologies Ltd.

F5102, Yunshenchu, Yuanlin Rd., Shatoujiao, Shenzhen, China. Zip 518081. Phn. ++86, 755, 2528 5648 Fax. 2528

eleading@vip.163.com sales@eleadingchina.com www.eleadingchina.com